

# MDT-300-34 (MILL DUTY THRUSTER BRAKES)



## INTRODUCTION

Thruster Brake is a device to retard the speed of moving machinery and to stop it accurately to the desired position. The breaking force is applied to the brake shoes by a pre-stressed compression spring. The shoes press on the rotating brake drum retarding its speed, and finally stopping it.

## TECHNICAL DATA

| ITEM                | BRAKE                           | THRUSTER                 |
|---------------------|---------------------------------|--------------------------|
| MODEL               | MDT - 300-34                    | ST- 535                  |
| DRUM DIA            | 300 mm                          | .....                    |
| BRAKE SHOE          | Asbestos free/BA                | .....                    |
| BRAKING TORQUE      | 62 Kg-m                         | .....                    |
| THRUST              | .....                           | 34 Kg                    |
| STROKE              | .....                           | 50 mm                    |
| OIL + CAPACITY      | .....                           | Transformer Oil 3 Litrs  |
| RATED VOLTAGE       | .....                           | 415V±10%,3PhAC,50Hz      |
| CURRENT AT 415 V AC | .....                           | 0.5 Amps                 |
| POWER               | .....                           | 150 Watt                 |
| INSULATION          | .....                           | F Class                  |
| INGRESS PROTECTION  | .....                           | IP-55 IS/IEC 60529(2001) |
| SURFACE TEMPERATURE | .....                           | +50°C                    |
| WEIGHT              | 35 kg                           | 16 kg                    |
| POWDER COATING      | Colour RAL 7021                 | .....                    |
| <b>OPTION</b>       |                                 |                          |
| LAF                 | Asbestos Free Liner             | .....                    |
| LWI                 | Lining Wear Indicator           | .....                    |
| OL                  | Open Brake Limit Switch         | .....                    |
| MS                  | Manual Opening & Locking System | .....                    |

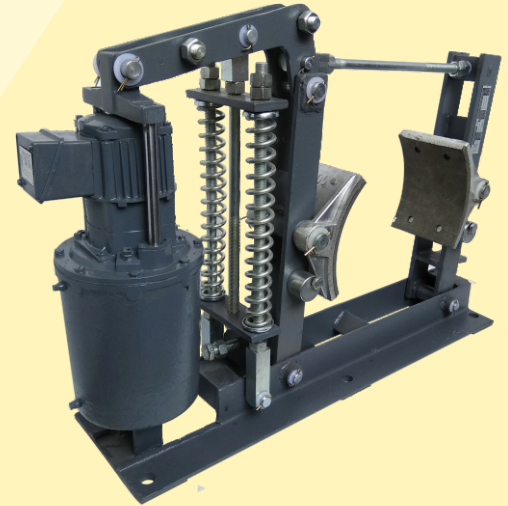

## SELECTION OF BRAKE SIZE

Electo-hydraulic thruster is a device which develops linear thrust (or force) required to operate the required mechanism. The input to the device is three phase supply.

The brake torque must be = > than motor full load as referred with drum. Formula as below:

$$T = \text{Torque in Kgm} = \frac{716 \times \text{Hp}}{\text{rpm}}$$

$$T = \text{Torque in Nm} = \frac{9552 \times \text{Kw}}{\text{rpm}}$$

Where Hp/Kw = motor output & rpm = Rev/minute

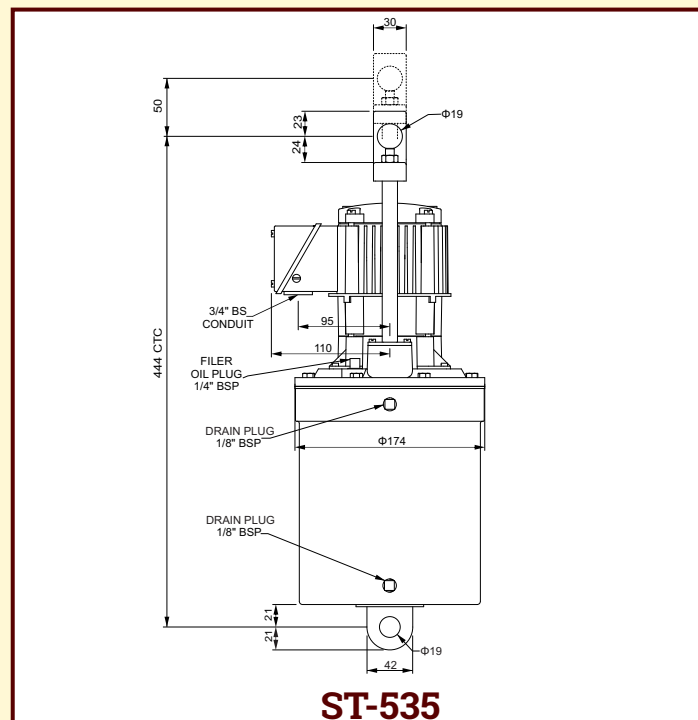
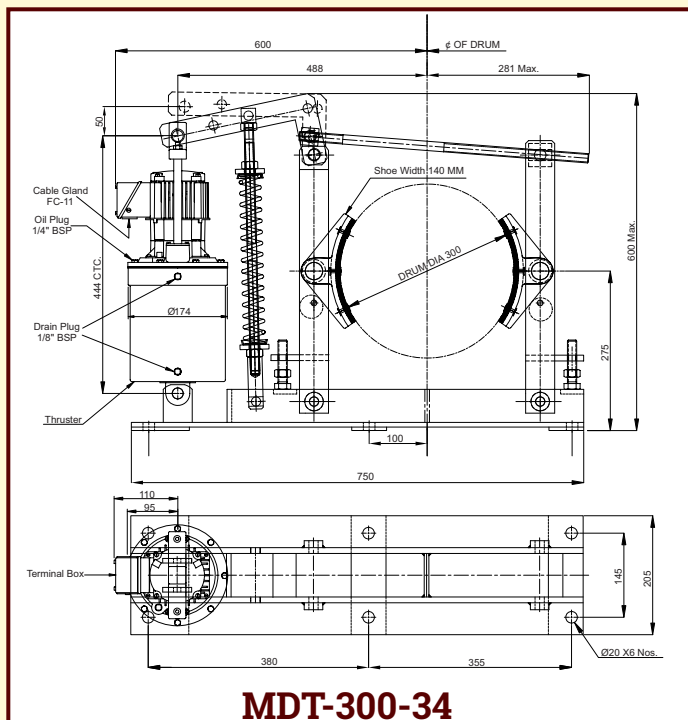

H. O. Unit -I : C-15/16, Nand Jyot Industrial Estate, Andheri-Kurla Road, Mumbai - 400072 ,  
Tel : (022) 42469700/730  
E-mail : sales@socgroup.in

Unit - II: Plot No. 4912, G. I. D. C., Phase IV, Vatva, Ahmedabad - 382445  
Tel.: (079) 68169700/702/712  
E-mail : enquiry2@socgroup.in

Visit us at :  
www.speedocontrols.com  
www.socremote.com  
www.socjoystick.com

**SPEED-O-CONTROLS PVT. LTD.**  
**CRANE CONTROL GEAR**

