

Thruster Brakes Eldro SMD (300-50/06)

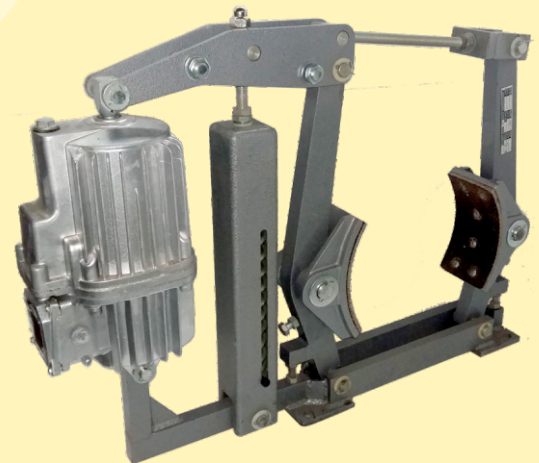

Technical Data

Item	Brake	Thruster
Model	SMD 300-50/06	ELD - 50/05
Drum Dia	300 mm	-----
Brake Shoe Friction Coefficient	Asbestos free Without Rivet / BA	-----
Braking Torque	105 - 1050 Nm	-----
Thrust	-----	30 Kg
Stroke	-----	50 mm
Oil + Capacity	-----	Transformer Oil IS-335 (1.6 Liters)
Rated Voltage	-----	415 V ± 10% 50 Hz 3Ph AC
Current at 415 V AC Inrush Current	-----	0.5 Amps 2.5 Amps.(Inrush)
Insulation	-----	F Class
Ingress Protection	-----	IP - 65 IS/IEC 60529 (2001)
Ambient Temperature	-----	50° C
Power	-----	200 Watt
Weight	50 Kg	14 Kg
Painting	Epoxy color RAL 7021	
SCD	Aluminum Brake Shoe as per DIN - 15435	
SPS/SS	Standard Pins / Staninless Steel	
LAF	Asbestos free linings with theoretical friction coefficient $\mu = 0.42$	



Selection of brake size

SMD Thruster brakes are steel fabricated frames with Eldro Thruster as per din standard.

Excellent designs & good manufacturing process ensure a reliable product.

The brake torque must be \Rightarrow than motor full load as referred with drum. Formula as below:

$$T = \text{Torque in Kgm} = \frac{716 \times \text{Hp}}{\text{rpm}}$$

$$T = \text{Torque in Nm} = \frac{9552 \times \text{Kw}}{\text{rpm}}$$

Where Hp/Kw = motor output & rpm = Rev/minute

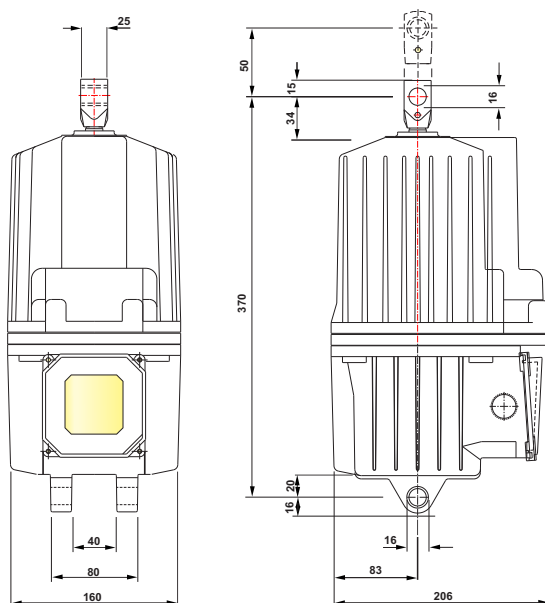

Eldro 30-05

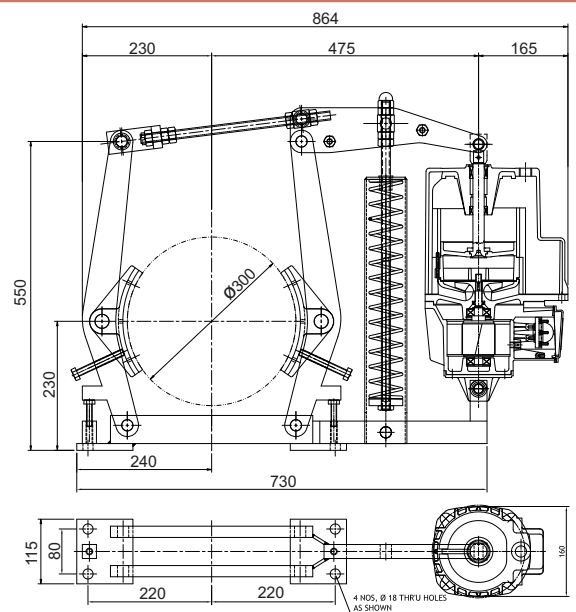

SMD 300-50

H. O. Unit - I : C-15/16, Nand Jyot Industrial Estate, Andheri-Kurla Road, Mumbai - 400072 ,
Tel : (022) 42469700-30
E-mail : sales@socgroup.in

Unit - II: Plot No. 4912, G. I. D. C., Phase IV, Vatva, Ahmedabad - 382445
Tel.: (079) 400832 01/2/3/4,
E-mail : sales.amd@socgroup.in

Visit us at :
www.speedocontrols.com
www.socremote.com

SPEED-O-CONTROLS PVT. LTD.
CRANE CONTROL GEAR